

LEGEND

- Application is made for rezoning of a portion of Erf 2841, Great Brak River from Agricultural Zone I to Subdivisional Area for a development consisting 68 Group Housing erven, private open spaces, private streets, utility erf and a public street.
- Application is made for subdivision of the Subdivisional Area as follows:
 - 68 Erven = Gen Res Zone I (ave size 220m²)
 - 2 Erven = Utility Zone
 - 11 Erven = Open Space Zone II
 - 5 Erven = Transport Zone III
 - 1 Erf = Transport Zone II

Portion Nos.	Zonings	Size (ha)	% of development	
1 - 21, 27 - 53, 58 - 75, 79 & 80	Gen Res Zone I	1,4937	28.45	
25, 85	Utility Zone	0.0167	0.32	
22 - 24, 54, 55, 76, 77, 81 - 84	Open Space Zone II	2.8163	53.64	
26, 56, 57, 78, 86	Transport Zone III	0.6712	12.78	
87	Transport Zone II	0.2525	4.81	
TOTAL		5.2504	100.00	

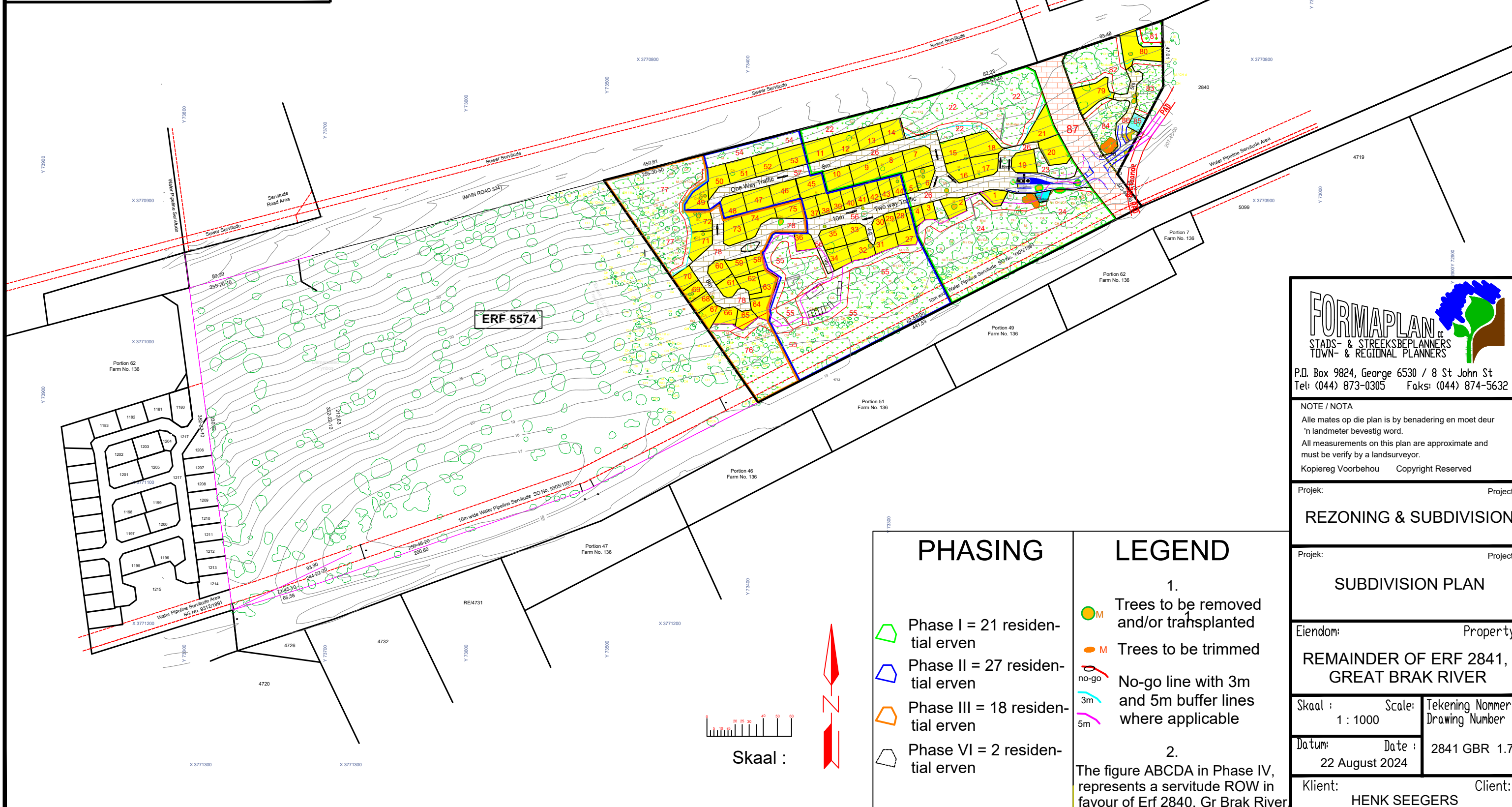

PHASING

- Phase I = 21 residential erven
- Phase II = 27 residential erven
- Phase III = 18 residential erven
- Phase VI = 2 residential erven

LEGEND

- Trees to be removed and/or transplanted
 - Trees to be trimmed
 - No-go line with 3m and 5m buffer lines where applicable
- The figure ABCDA in Phase IV, represents a servitude ROW in favour of Erf 2840, Gr Brak River

FORMAPLAN

STADS- & STREEKSBEPLANNERS
TOWN- & REGIONAL PLANNERS

P.O. Box 9824, George 6530 / 8 St John St
Tel: (044) 873-0305 Faks: (044) 874-5632

NOTE / NOTA
Alle mates op die plan is by benadering en moet deur 'n landmeter bevestig word.
All measurements on this plan are approximate and must be verify by a landsurveyor.
Kopiereg Voorbehou Copyright Reserved

Projek: Project:
REZONING & SUBDIVISION

Projek: Project:
SUBDIVISION PLAN

Eiendom: Property:
REMAINDER OF ERF 2841, GREAT BRAK RIVER

Skaal : Scale:
1 : 1000 Tekening Nummer:
Drawing Number

Datum: Date :
22 August 2024 2841 GBR 1.7

Klient: Client:
HENK SEEGER